

# SIRRINE HALL REPLACEMENT CLEMSON UNIVERSITY



# TEAM QUALIFICATIONS

## LS3P CLEMSON EXPERIENCE



## LMN BUSINESS EDUCATION + CIVIC



## OLIN CAMPUS LANDSCAPE DESIGN



# LS3P DESIGN EXCELLENCE



LS3P named 2014 Southeast  
**DESIGN FIRM OF THE YEAR**  
BY ENGINEERING NEWS RECORD (ENR)

450+ DESIGN AWARDS

13 MILLION+  
SQUARE FEET OF LEED  
CERTIFIED CONSTRUCTION

139 LEED  
CERTIFIED PROJECTS

OVER 200 MILLION  
SQUARE FEET DESIGNED



# LS3P PROJECT EXPERIENCE ON THE CLEMSON CAMPUS

2014

Clemson University IDC

Greenville One

2015

West End Zone - Phase III

Memorial Stadium Suite

Renovations

Ongoing

Littlejohn Coliseum



# LMN DESIGN EXCELLENCE



AIA National Firm  
Award 2016

200+ INTERNATIONAL, NATIONAL,  
REGIONAL & LOCAL AWARDS

2 Business Week GOOD  
DESIGN IS GOOD BUSINESS  
AWARDS

World Architecture  
News EFFECTIVENESS AWARD

LS3P | LMN | OLIN

LMN TECH STUDIO  
INTEGRATED DESIGN TECHNOLOGY  
STUDIO

32 LEED PROJECTS

Living Building Pilot  
Program



# CIVIC / CULTURAL





# COMMERCIAL





# WORKPLACE DESIGN





# HIGHER EDUCATION 100+ PROJECTS ON 26 CAMPUSES





# BUSINESS EDUCATION

**Foster School of Business**  
University of Washington



**Huntsman School of Business**  
Utah State University



**Broad College of Business Graduate Pavilion**  
Michigan State University

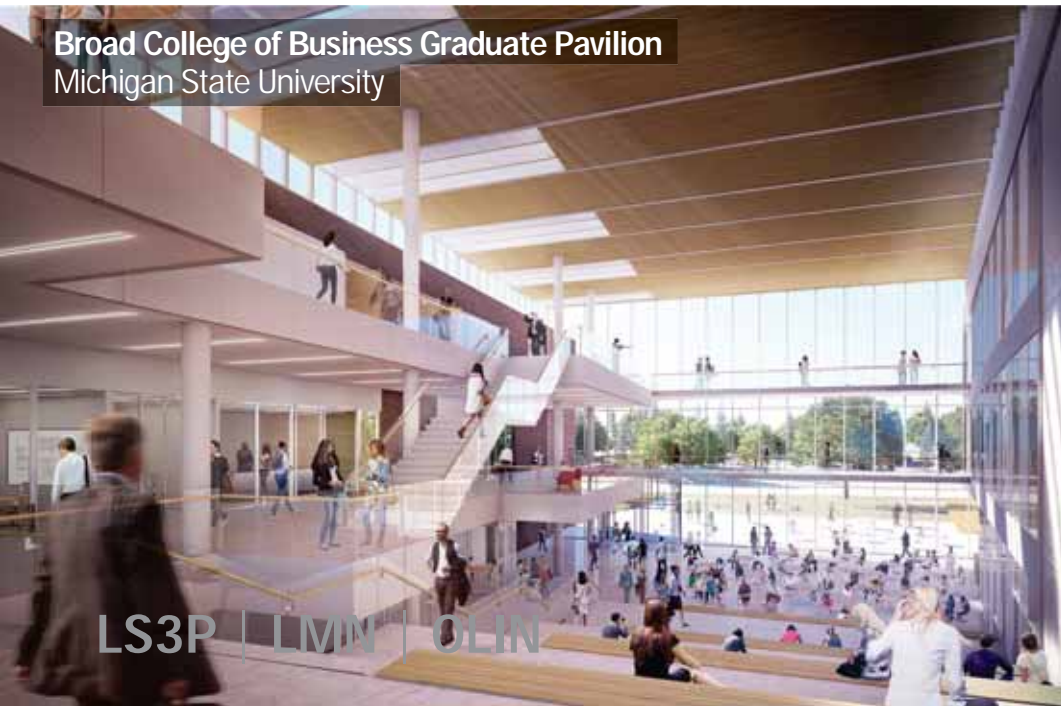

LS3P | LMN | OLIN

**Merage School of Business Addition**  
University of California, Irvine

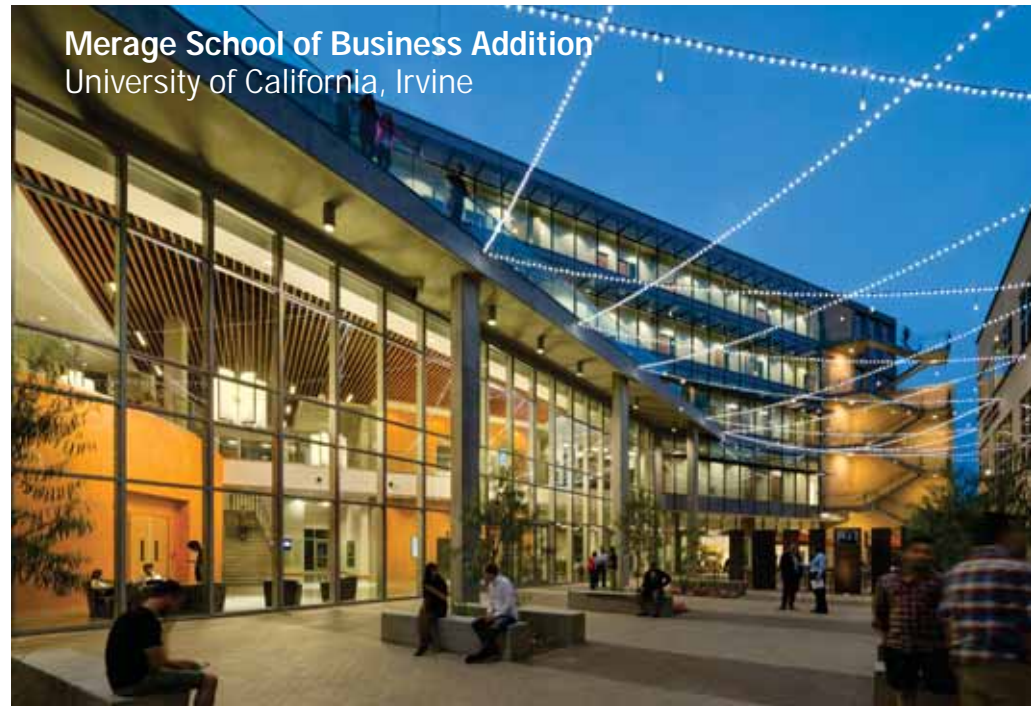



# RELEVANT EXPERIENCE



LS3P | LMN | OLIN



# FOSTER SCHOOL OF BUSINESS PACCAR HALL UNIVERSITY OF WASHINGTON



*"It is clear that the extensive planning process undertaken with the business school faculty, including their tours of peer institutions, enabled all to develop this most responsive design."*

2011 AIA COMMITTEE  
ON ARCHITECTURE FOR  
EDUCATION AWARDS JURY



*“The way business is taught today involves exposing students to the concept of **teams** – their power, effective operation, psychology and dynamics within the corporate framework.”*

JAMES JIAMBALVO, DEAN OF FOSTER SCHOOL OF BUSINESS UNIVERSITY OF WASHINGTON

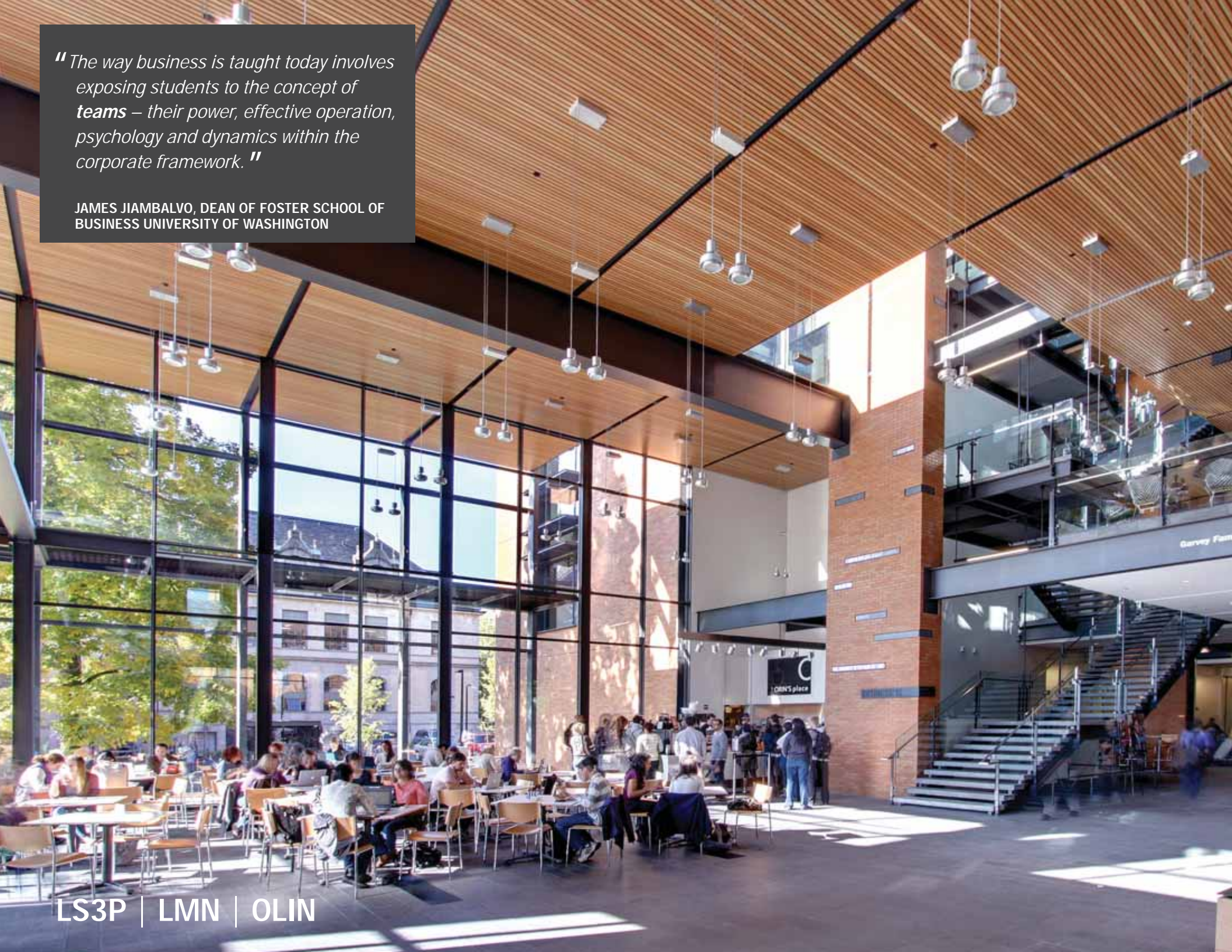





LS3P | LMN | OLIN





LS3P | LMN | OLIN



# HUNTSMAN SCHOOL OF BUSINESS

## UTAH STATE UNIVERSITY



LS3P | LMN | OLIN





LS3P | LMN | OLIN





LS3P | LMN | OLIN



# BROAD COLLEGE OF BUSINESS GRADUATE PAVILION MICHIGAN STATE UNIVERSITY



LS3P | LMN | OLIN







# UNIVERSITY OF CALIFORNIA IRVINE MERAGE SCHOOL OF BUSINESS ADDITION





# COMMUNITY COURTYARD





# OUTDOOR CAFE

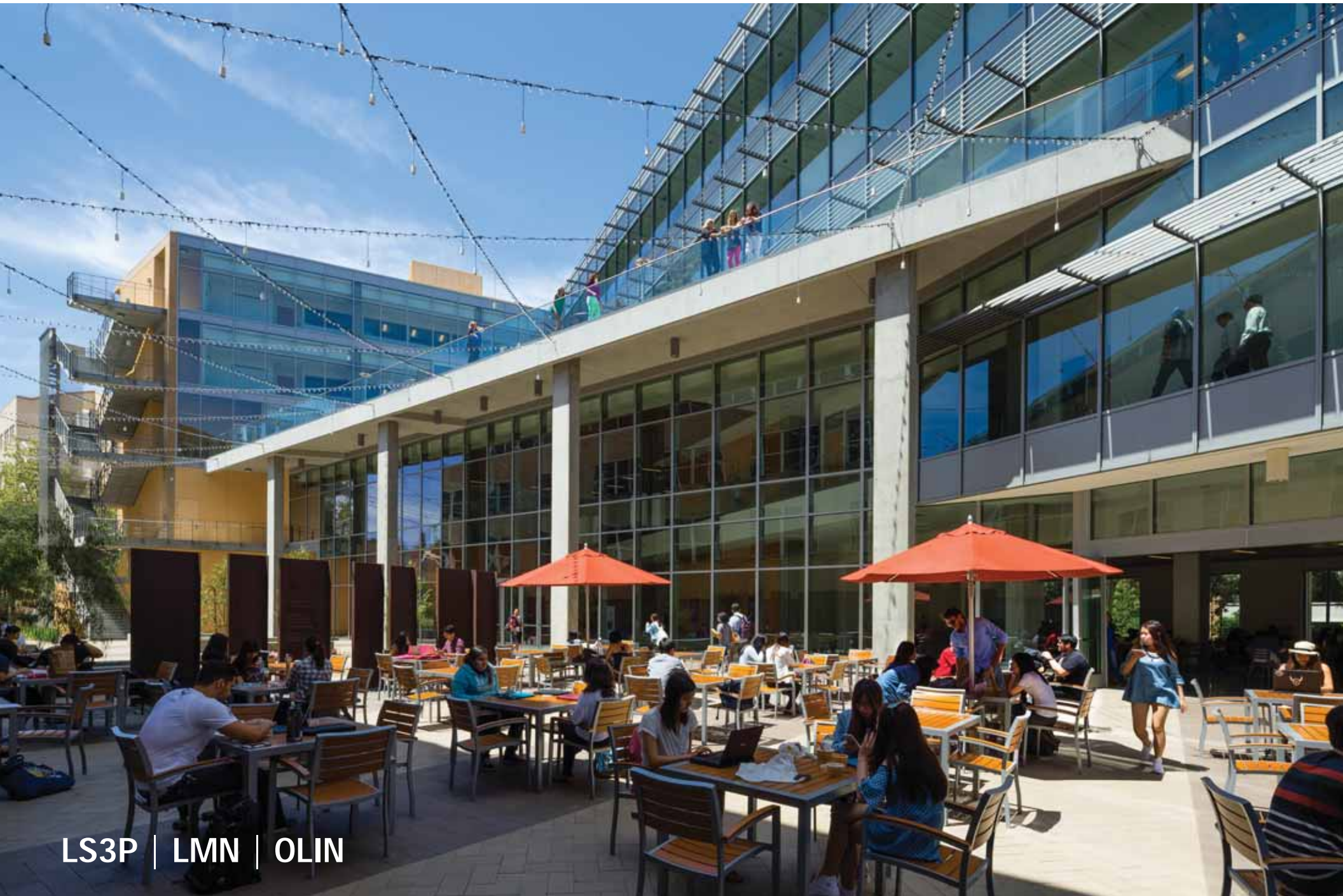



# DESIGN APPROACH





# DESIGN APPROACH

**PROGRAM FUNCTIONALITY**  
**SOCIAL PERFORMANCE**  
**CAMPUS ENGAGEMENT**



# SITE ANALYSIS



LS3P | LMN | OLIN



# CAMPUS GROWTH - PRESENT





# PROPOSED CIRCULATION

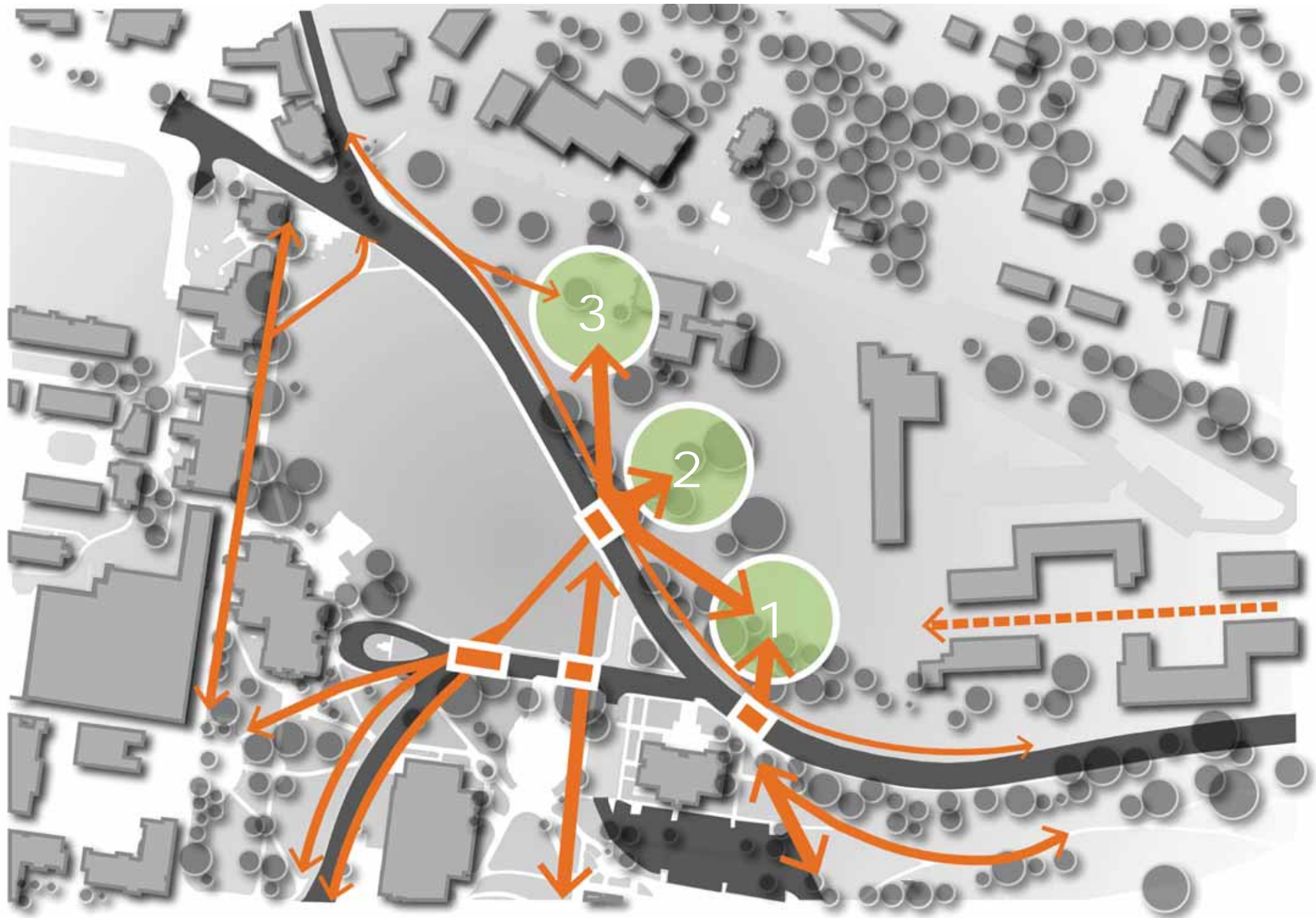



# APPROACH





# FEASIBILITY STUDY

## Classrooms and Education Spaces

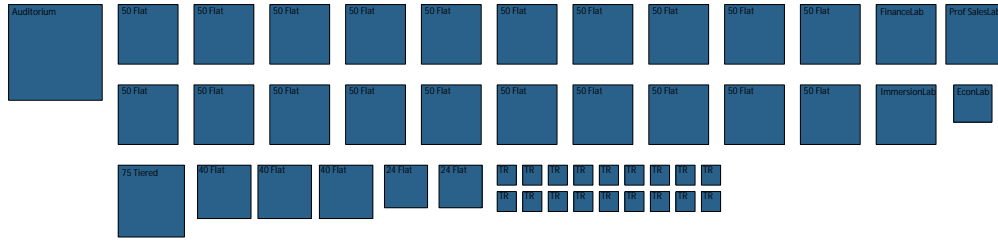

## Shared Spaces



## Faculty Offices and Support Spaces

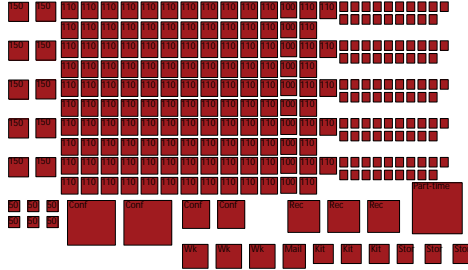

## Student Services

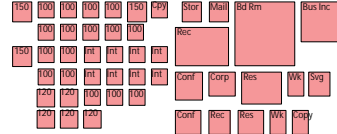

## Administration

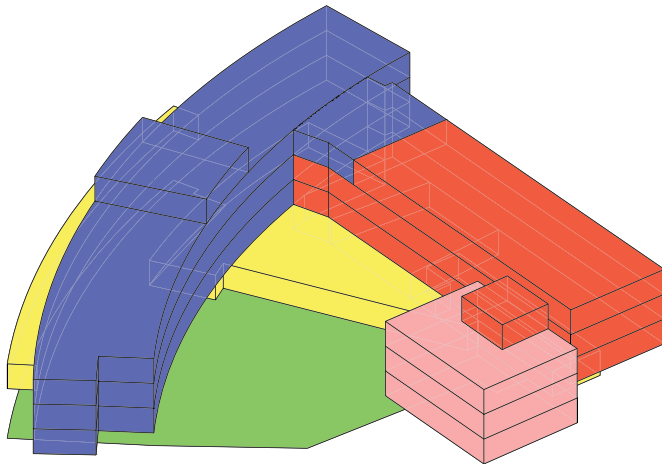
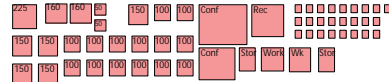



# TILLMAN AXIS

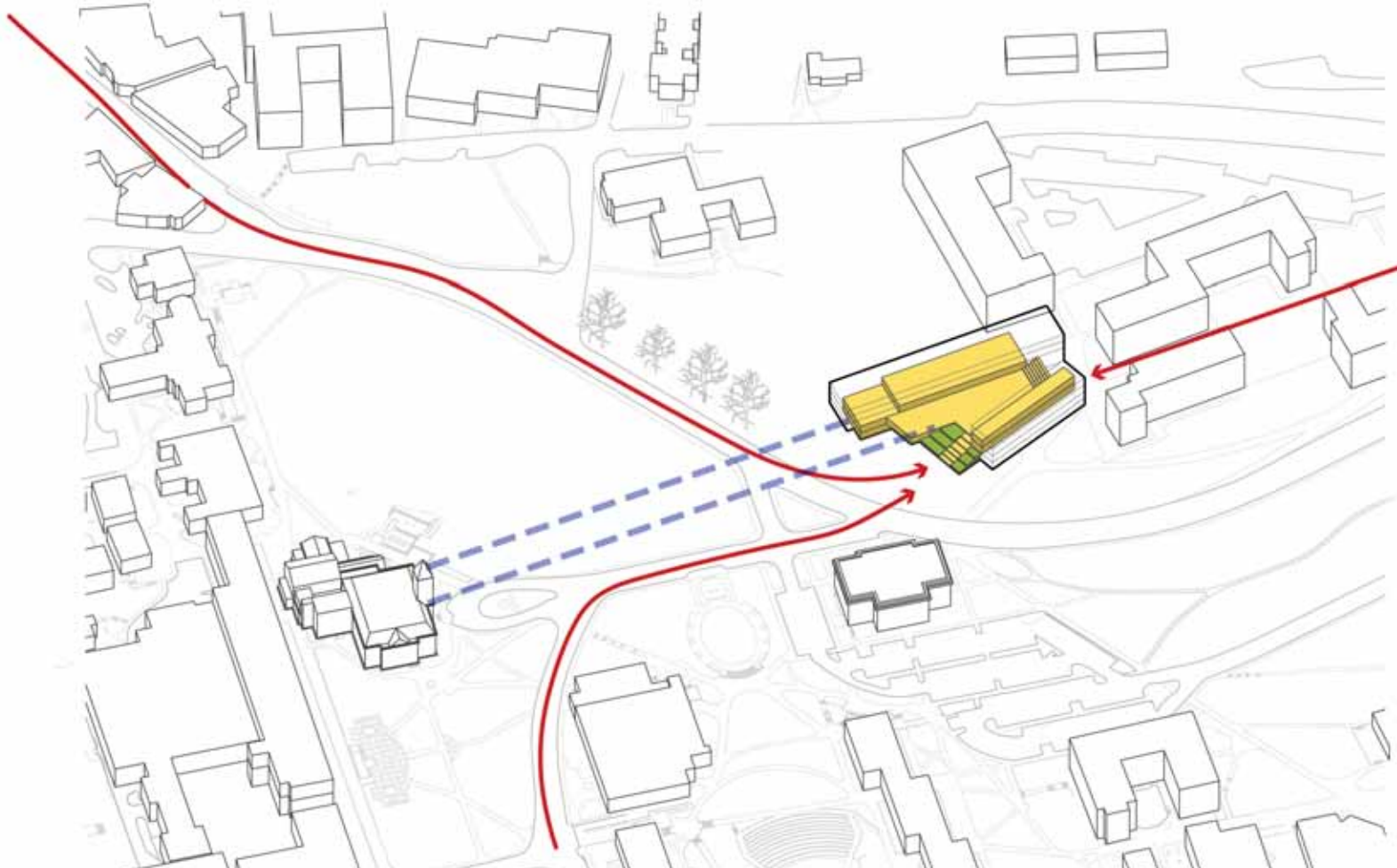
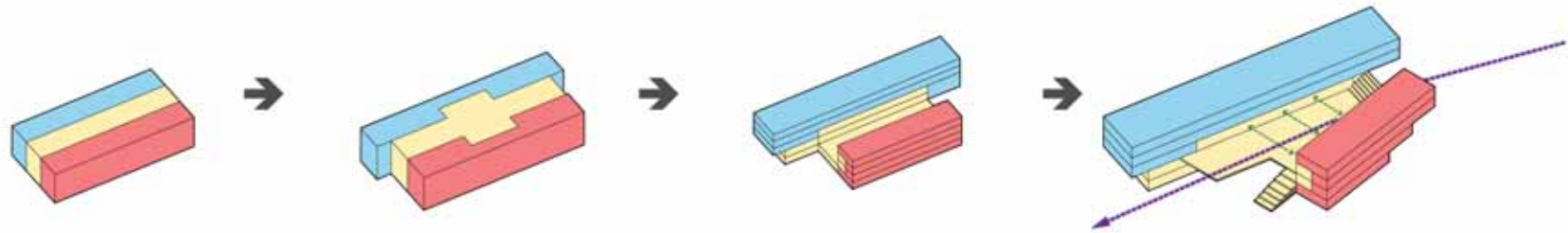



# TILLMAN AXIS





# TILLMAN AXIS





# TILLMAN AXIS





# CRESCENT GROVE

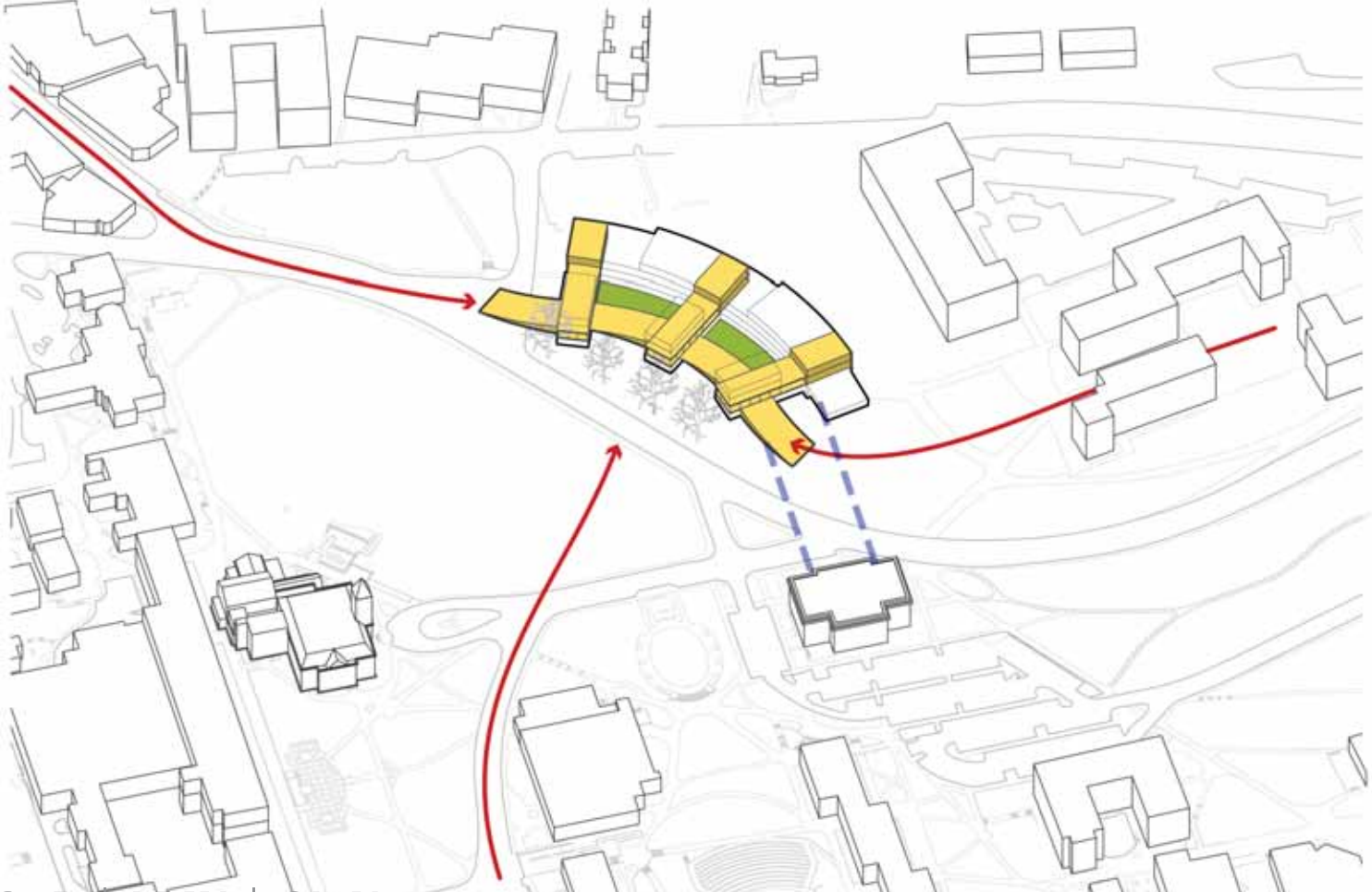
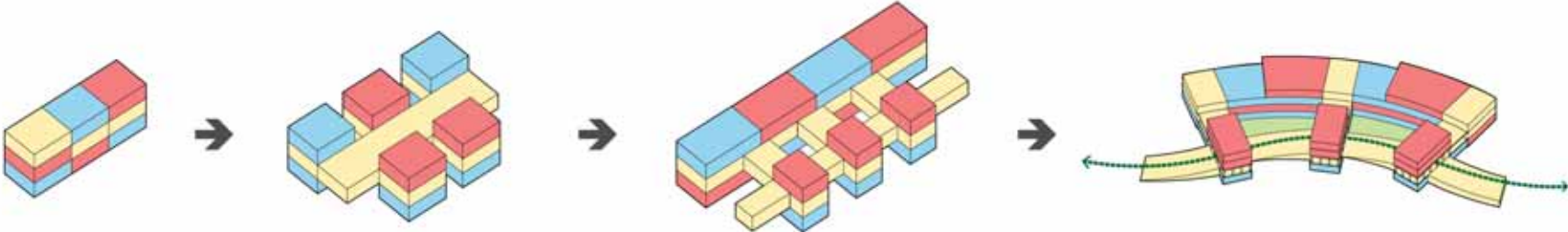



# CRESCENT GROVE





# CRESCENT GROVE





# CRESCENT GROVE





# BOWMAN SLOPE





# BOWMAN SLOPE





# BOWMAN SLOPE





# BOWMAN SLOPE





# Q&A

